

## WHAT TOOLS DO I NEED FOR THE INSTALLATION PRODCESS?

- **Pry Tool / Flathead Screwdriver**
- **Dremel / Cut Tool / Power Drill**
- **Epoxy Adhesive** (optional)
- **Rubberwerkz Butyl Sealant**
- **Oven** (optional)
- **Beading Wire** (optional)
- **Surgical Powderless Gloves** (optional)



## STEP ONE: OPENING YOUR HEADLIGHTS

Before anything, you'll want to determine what type of sealant was originally used to seal your headlights.

**Butyl Sealant** (which will typically only take 1 cycle in the oven)

OR

**Permaseal** (which could possibly require a few cycles in the oven).

Once you determine the type of sealant you're dealing with, there's 2 main methods installers use to take them apart:

**Method 1:** Pre-heat oven to 215°. Remove any metal screws from the lens/housings and place headlight in oven for 12 minutes at a time until they pull apart. Some headlights take more cycles than others. Using a flat head screwdriver you will pry the headlight open in 3" increments until the lens is completely loose/detached. \*Time and temperature may vary based on your vehicle / oven.

**Method 2:** Some prefer to avoid the oven and simply use a dremel or some sort of cutting tool. If you'd rather use a tool, you're going to want to cut along the lens where it meets the plastic of the headlight. Make sure to not cut too deep on your first swipe around or it will melt the plastic and cause buildup around the edges of the headlight.

## STEP TWO: CONNECTING YOUR HALOS

We strongly suggest you make sure your halos are connected and working properly prior to mounting them and resealing your headlights.

\*Please refer to the wiring diagrams on the backside of this brochure for specific wiring instructions.

**De-Pin the JST Connection** found on the end of your halo (as shown below).

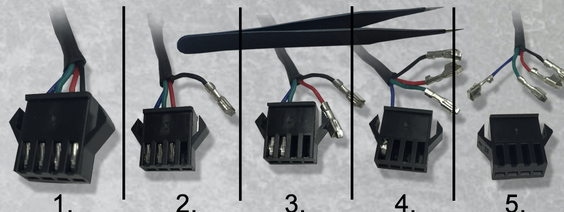

This is a simple but tedious process, we recommend using our Pick-EZ Tweezer Tool (shown below) or any Pick Tool to apply pressure to the metal pins (one at a time) removing each of them from the backside of the connector.

Once you remove the metal pins from the connector, you're going to drill a small 1/4" hole (just enough to fit the 4 pins through) into the bezel of your headlight housing. Once you feed the pins into the hole through your bezel you can simply insert them back into the JST connector. \*Please refer to the wiring diagrams on the backside of this brochure for specific wiring instructions.

## STEP THREE: MOUNTING YOUR HALOS

There's many ways to mount your halos once they're functioning, here are a few methods we recommend:

1. **Use the 3M Adhesive Tape** found on the backside of your halo ring, be sure to sand the surface you'll be applying the halos to before doing so.
2. **You can use your every day 2 part Epoxy:** simply spread it along the backside of the halo and stick it onto the desired location.
3. **Use the Beading Wire method,** which would require drilling two very small holes on each side of the halo and running wire across the top of the halo and through the holes. Once the wire is ran through and you feel as if the halo is secure, simply twist lock the open ends together on the backside of the headlight until firm.

## STEP FOUR: ENJOY YOUR NEW LIGHTS!

**LIGHTING  
TRENDZ**



**INSTALL  
MANUAL**

PH: 973-803-2834

WWW.LIGHTINGTRENDZ.COM