

# **RYDEEN®**

find your road



**Owner's Manual**

***TOMBO 360X***

**360° Rearview Mirror Touchscreen  
4K HD Dash Camera**



# Contents

<b>1. Welcome Statement &amp; Warnings .....</b>	<b>2</b>
<b>PRECAUTIONS &amp; WARNINGS .....</b>	<b>2</b>
<b>2. What's in the Box .....</b>	<b>5</b>
<b>OPTIONAL ACCESSORIES.....</b>	<b>7</b>
<b>3. Product Overview.....</b>	<b>8</b>
Wiring Diagram .....	10
<b>4. Installation .....</b>	<b>11</b>
Universal Mount Solution.....	11
Mirror Replacement Method.....	12
Optional Accessories Installation .....	15
<b>5. User Interfaces .....</b>	<b>16</b>
Video Recording Icon.....	17
Photo Icon.....	18
Replay Video and View Photo Icon .....	18
File Lock Icon .....	19
Setting Menu Icon .....	19
Display Mode Selection Icon .....	21
Screen Display Mode Introduction .....	21
To SSD Icon .....	22
<b>6. Video Player Installation (PC Only) .....</b>	<b>24</b>
<b>7. Specifications .....</b>	<b>28</b>
<b>8. Maintaining Your GPS.....</b>	<b>29</b>
<b>9. Technical Support Contact Info .....</b>	<b>29</b>
<b>10. One Year Limited Warranty .....</b>	<b>29</b>
<b>11. To Obtain Warranty Service.....</b>	<b>30</b>
<b>12. FCC Compliance Statement.....</b>	<b>31</b>
<b>13. Copyright .....</b>	<b>31</b>
<b>14. Disclaimer .....</b>	<b>32</b>
<b>15. Troubleshooting .....</b>	<b>32</b>

# 1. Welcome Statement & Warnings

Congratulations and thank you for purchasing RYDEEN TOMBO 360X, our 360-degree surround view mirror monitor DVR. We hope you will enjoy using this exciting product and trust that it will make your driving experience more comfortable and hassle-free. The TOMBO 360X is a 10-inch high-definition borderless touch screen rearview mirror equipped with a 360-degree high-definition digital camera, which will provide the driver with a high-definition 360-degree view of the interior and exterior of the vehicle. Use the TOMBO 360X rearview camera of the vehicle at your command. When shifting into reverse, it will automatically display in full-screen the backup camera to provide you with a reference when backing out. If the use of the display is no longer needed, the display can be turned off manually to serve as a rearview mirror only and continue video recording in the background.

Please read this Owner's Manual carefully. After you have finished reading the instructions, keep this document in a safe place for future reference. If you have any further questions about your TOMBO 360X operation, feel free to call RYDEEN, Toll Free at 1-877-777-8811 (within USA only) for product support, or visit our website: <https://rydeenmobile.com/contact-support/>

## PRECAUTIONS & WARNINGS

### IMPORTANT INFORMATION

### PLEASE READ THIS MANUAL CAREFULLY BEFORE USING THE PRODUCT

The product aims to provide a 360-degree panoramic view of the inside and outside of the vehicle, and will provide you with a safer, more comfortable and convenient driving experience. Therefore, we recommend that you read and follow all the information and instructions in this user manual to make your TOMBO 360X achieve the best performance and satisfaction.

- Your TOMBO 360X **IS NOT** a substitute for personal judgment. The field of view of the backup camera of this product is limited. Some objects, roads and other vehicles may not be visible. **ALWAYS LOOK AHEAD, LOOK AROUND, KEEP A SAFE DISTANCE FROM OTHER VEHICLES WHEN DRIVING AND PARKING, DO NOT JUST USE A REARVIEW MIRROR. DO NOT DEPEND SOLELY ON THE PRODUCT FOR COMPLETE FIELD OF VIEW.**



- Objects displayed in the mirror may be closer than they appear. When changing or merging into a lane, please check your sideview mirrors and check your surroundings of the vehicle to avoid injury, death or vehicle damage that may be caused by this operation.
- **DO NOT OPERATE THIS PRODUCT or TOUCHSCREEN WHILE THE VEHICLE IS IN MOTION**, as those actions may affect safe driving. If you need to operate, please park the vehicle in a safe area before performing elated operations.
- **SEVERE INJURY RISK - DO NOT** mount your TOMBO 360X on the surface or in the deployment field of your vehicle's driver and passenger airbag units.
- **SEVERE INJURY RISK - SECURE THE MOUNTING** of your TOMBO 360X firmly, to avoid the risk of injury to the passengers in the event of a vehicle accident or collision.
- Position the unit in a location that does not obstruct the driver's view of the road, instruments or vehicle controls.
- Make sure that the TOMBO 360X device and the provided bracket or adhesive are properly attached to the vehicle's windshield.
- DO NOT attempt to modify or disassemble the TOMBO 360X unit. Personal injury or damage could result. If a problem occurs, stop using the system immediately and contact RYDEEN. Changes or modifications to the TOMBO 360X will void the warranty and its compliance with FCC rules.
- If you notice any of the following: (Unidentified liquid on the unit; smoke rising out of the unit; unusual odor emanating from the unit) – **STOP USING THE UNIT IMMEDIATELY.** Contact the nearest RYDEEN retailer or call RYDEEN Customer Service for assistance Toll Free @ 1-877-777-8811 (within USA only).
- DO NOT mount your TOMBO 360X on any non-automotive form of transportation (motorcycles, bikes, ATV's, watercraft).
- The appearance of the product shown in this manual may be different from the actual product, please refer to the actual product.
- The picture examples used in this manual may be different compared to the actual vehicle, please use as reference.
- The picture examples used in this manual may be different compared to the actual user interface of this device, please use as reference.



## WARNINGS



- **DO NOT DROP ANY COMPONENTS OF THIS PRODUCT.** Excessive shock due to dropping any components in the system or subjecting it to excessive shock and vibrations may cause malfunction and is not covered by warranty.
- **DO NOT** use any sharp object to operate your unit's touch-screen display. Excessive force could damage the LCD display.
- Keep the TOMBO 360X unit out of reach of small children. Removable parts (microSD memory card) can be a choking hazard.
- **The TOMBO 360X Unit IS NOT WATERPROOF.** Avoid exposing it to rain or other forms of excessive moisture.
- **Water damage is not covered under the warranty.**



## **WARNINGS**



- **This product is only used as a reference for investigating incidents or traffic accidents.**
- **This product cannot guarantee to record all incidents.**
- **THE FOLLOWING INSTRUCTIONS ARE RECOMMENDED FOR AUTHORIZED RYDEEN MOBILE INSTALLERS.**

## 2. What's in the Box

When opening the packaging box of this product, please make sure that all product accessories are complete.



**TOMBO 360X Main Unit**

Item	Description
1	Power Input
2	GPS Input
3	USB Type-C Connector, For External Storage Device
4	Blind Spot LED Input
5	Backup Camera Input
6	Proximity Sensor Input



**Backpack Adaptor for Mirror Stem**



**Proximity Sensor(A)**



**AHD Backup Camera(B)**



**GPS Unit(C)**



**Power Wire Harness for Hardwire Installation(D)**



**AHD Camera Extension Cable(B)**



**VSM-AV Mirror Stem Fit Most Vehicles(E)**



**Velcro Straps Pre-Installed on the Mirror**



**Mirror Cleaning Cloth(F)**



**D-Tab(F)**



**Mounting Adhesive(G)**



**L-shaped Tool for MV Series(F)**



**Type C-USB Adaptor(F)**



**MicroSD Inserted in Slot**



**Screw Driver(H)**



**Backpack Plate Screws(H)**

**Note:** Polybags are labeled (A-H) for ease of reference. Screws size: a (PM2.5\*8mm), b (PM3\*10mm).

## OPTIONAL ACCESSORIES



If you want to purchase the optional accessories, please contact your retailer or contact RYDEEN, Toll Free at 1-877-777-8811 (within USA only) for product support, or visit our website: <https://rydeenmobile.com/>

### RYDEEN EXT-026 (SOLD SEPARATELY)



LED Indicators Cable for Rydeen Blind Spot (BSS) Products (for BSS2x, BSS3x, BSS2, BSS3, BSS1LPB, BSS2LPBC, BSS2LPB, please contact tech support for BSS-ONE and CUB BSD products installation instructions)

### RYDEEN VSM-UNI2 (SOLD SEPARATELY)



23mm 24mm 25mm



26mm 27mm

Mount Adaptor Inserts  
23mm-27mm



Universal Mount  
Adaptor (Large)



14mm 15mm 16mm 17mm 18mm



19mm 20mm 21mm

Mount Adaptor Inserts  
14mm-21mm



Universal Mount  
Adaptor (Small)



L-Shape Mount Stem



Screws

### RYDEEN BRK01 (SOLD SEPARATELY)



Box Shape Camera  
Bracket



U-Shape Camera  
Bracket



Backup Camera  
Screws

### 3. Product Overview

#### TOMBO 360X

FRONT

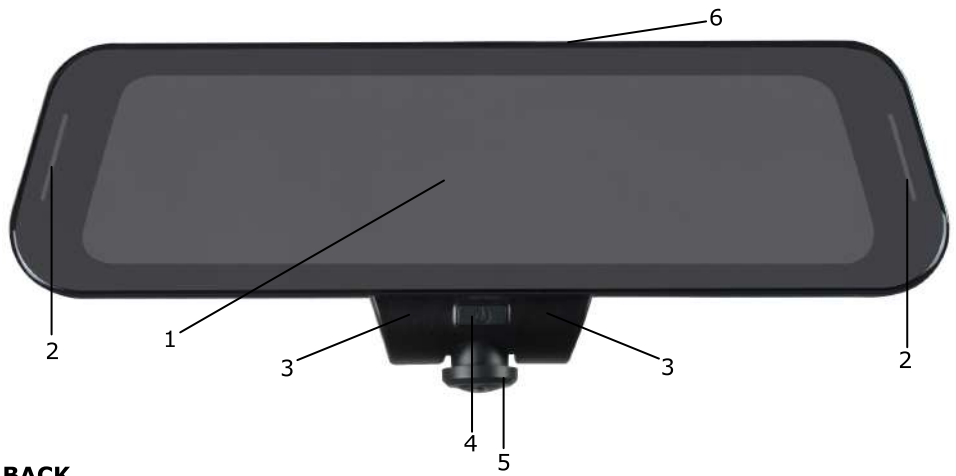

BACK

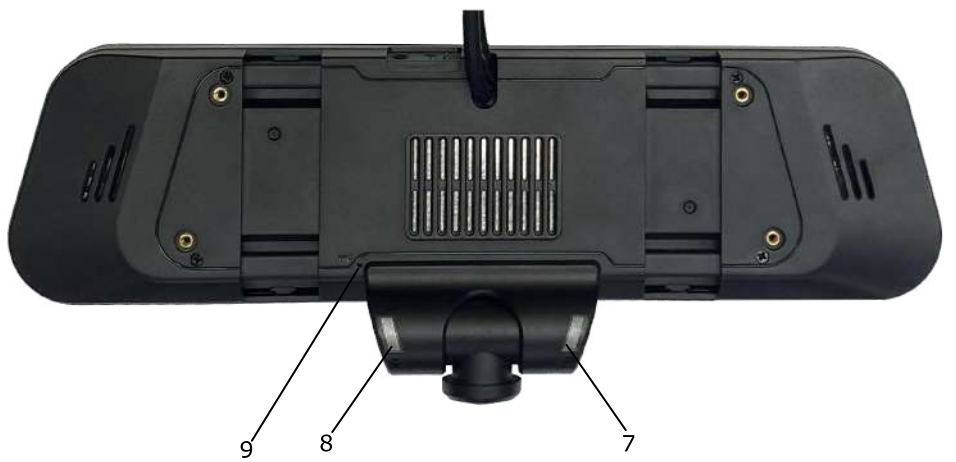

**BOTTOM**



No.	Item	Description
1	Touch screen	Set basic functions by touching the screen.
2	LED lights	When the TOMBO 360X is connected with a blind spot detection monitoring system, the LED lights will indicate when a vehicle is inside the detection zone.
3	IR lights	Equipped with six infrared lights for night time visibility for the exterior & interior of vehicle.
4	Power button	Short press to (turn On/Off) the LCD Monitor. Long press to Power On/Off.
5	Front camera	A fisheye camera with a 360-degree view.
6	MicroSD card slot	Use the screw driver provided with this product to open the cover of the microSD card slot and insert or remove the microSD card.
7	LED indicator	While video recording is in process, the blue LED indicator is turned off. When video recording function is off, the LED indicator will flash. You can enable or disable the LED indicator within the menu.
8	Photo sensor	The photo sensor turns the IR on/off by sensing the intensity and brightness of the ambient lighting around the vehicle. It will also adjust the screen brightness automatically.
9	MIC hole	The MIC hole can record sound, which can be turned on or off in the setting menu.
10	Reset hole	Press and hold within reset hole to restart the TOMBO 360X.

## Wiring Diagram

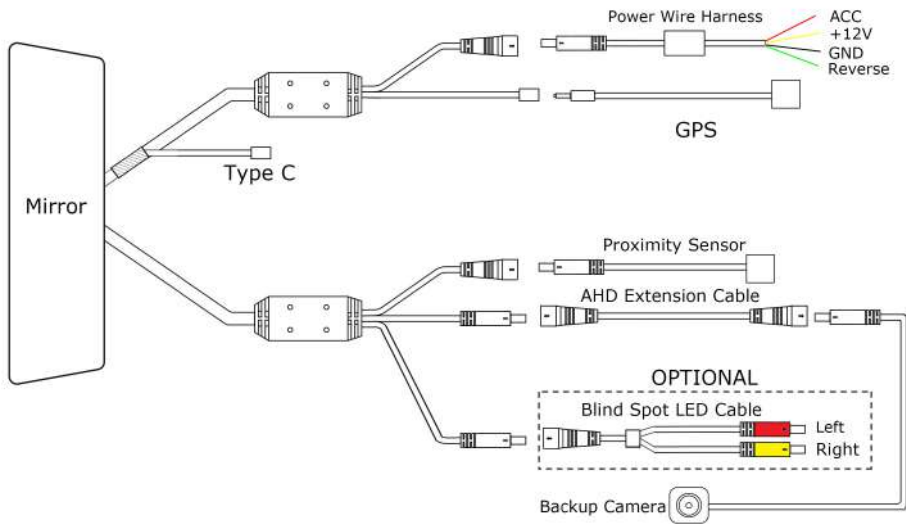

**Note:** If you want to purchase the optional accessories, please contact your retailer or contact RYDEEN, Toll Free at 1-877-777-8811 (within USA only) for product support, or visit our website: <https://rydeenmobile.com/>

### RYDEEN EXT-026 (SOLD SEPARATELY)



LED Indicators Cable for Rydeen Blind Spot (BSS) Products (for BSS2x, BSS3x, BSS2, BSS3, BSS1LPB, BSS2LPBC, BSS2LPB, please contact tech support for BSS-ONE and CUB BSD products installation instructions)



## 4. Installation



- **THE FOLLOWING INSTRUCTIONS ARE INTENDED TO GIVE YOU A BRIEF GUIDANCE FOR INSTALLATION.**
- **Dropping your TOMBO 360X unit or subjecting it to excessive shock and vibrations as this may cause it to malfunction and is not covered by warranty.**
- **The TOMBO 360X unit IS NOT WATERPROOF. Avoid exposing it to rain or other forms of excessive moisture. Water damage is not covered under the warranty.**
- **Most vehicles have the mirror mounted directly onto the glass, therefore improper tools or techniques used in the installation could result in a damaged or broken windshield. Rydeen is not responsible for damages to windshield caused by installation processes.**

### Universal Mount Solution

Paste the adhesive provided in the position as shown in the picture below. This will prevent vibration and protect the original rear-view mirror from being scratched. Use the provided Velcro straps (pre-installed on the mirror) loop the Velcro straps around the original mirror and tighten down the strap.

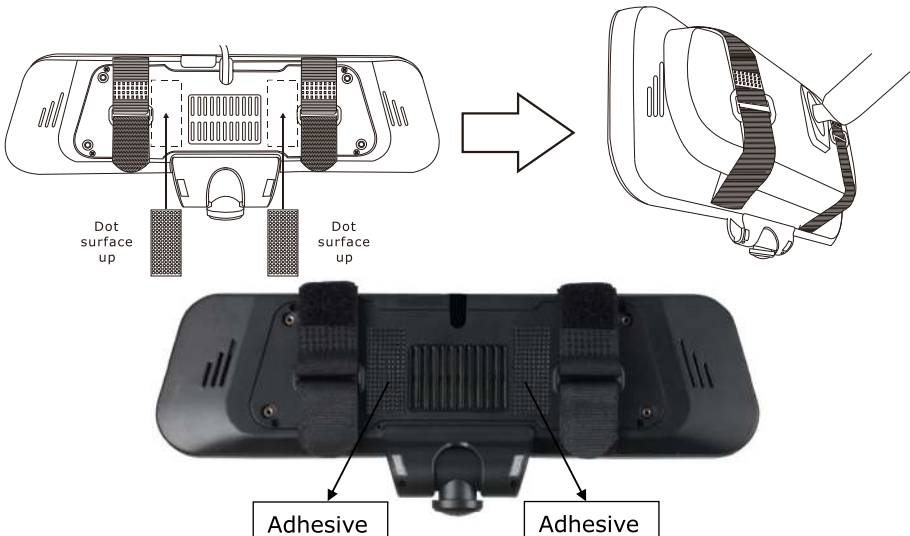

## Mirror Replacement Method

### Step 1

Remove the existing mirror and unplug the connector, if one exists. (Note: All vehicles use different mounting solutions. If necessary, consult your local automotive dealer or installation professional for specific instructions.



**Note:** If your vehicle uses a universal D-Tab mount, do not remove the D-Tab and use the VSM-AV mount provided.

- 1) Insert TOMBO 360X Mirror Back Plate for windshield mount onto the back side of the TOMBO 360X mirror, using provided screws.
- 2) Attach VSM-AV mount onto the TOMBO 360X Back Plate using provided screws and allen key.
- 3) Reattach the TOMBO 360X mirror by sliding the VSM-AV mount onto the factory windshield tab.
- 4) Adjust to the suitable angle to the mirror, then proceed to **Step 2**.

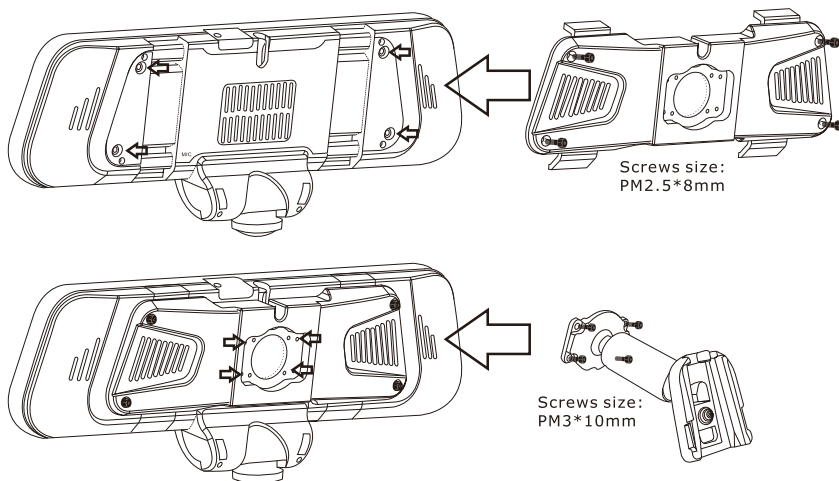



**Note:** If the included VSM-AV mount does not fit the factory windshield tab, please use the VSM-UNI2 (SOLD SEPARATELY). Please contact RYDEEN Technical Support at [tech1@rydeenmobile.com](mailto:tech1@rydeenmobile.com) or call 310-787-7880, toll-free 877-777-8811 for more details.

## Step 2

Connect each unit according to the wiring diagram (page 10).

- 1) Route the wires along the interior trim panel and go down the A-pillar, use the pry tool (not included) to tuck the wires within the panels. Make your ACC, +12V, GND and Reverse Trigger connections.
- 2) Follow the wiring diagram, install the backup camera and other accessories.

### For Cars

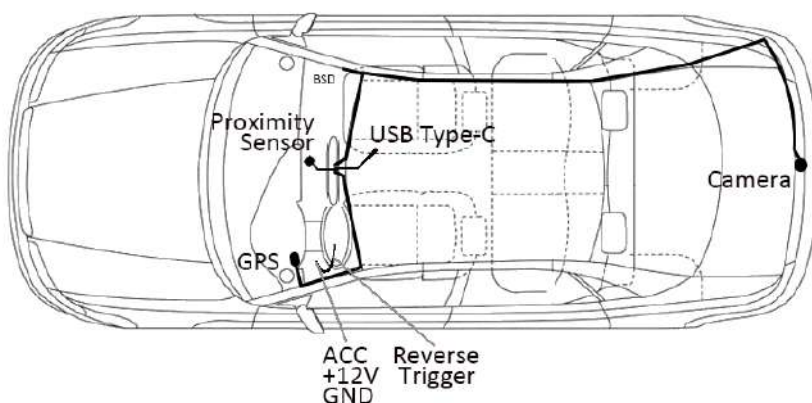

### For Trucks

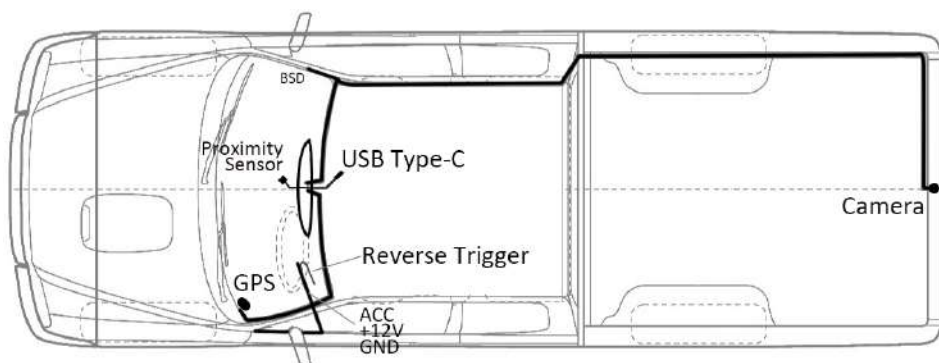

### Inside View

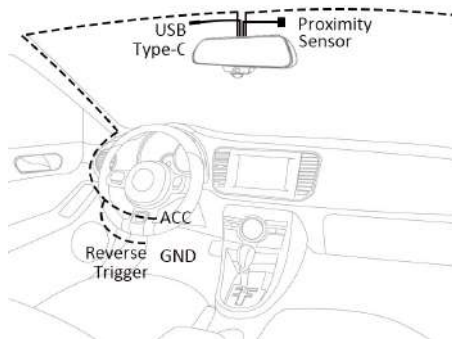

### Backup Camera Installation Position Option Diagram

Rear windshield mounting location (Interior Top Mounted)

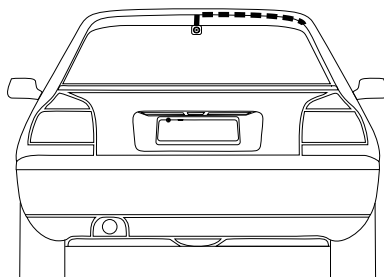
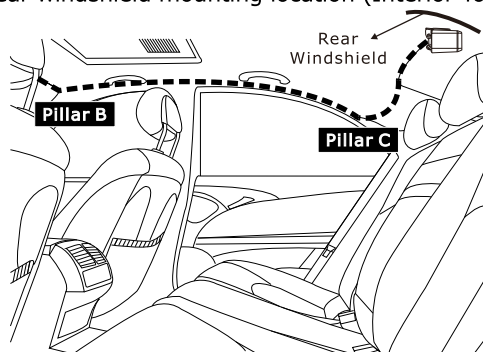

Above license plate mounting location (Exterior Mounted)

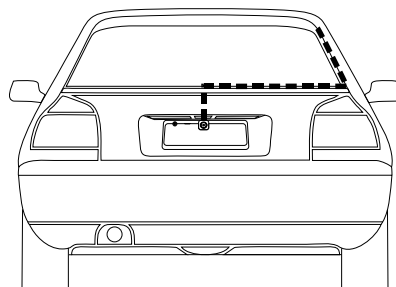
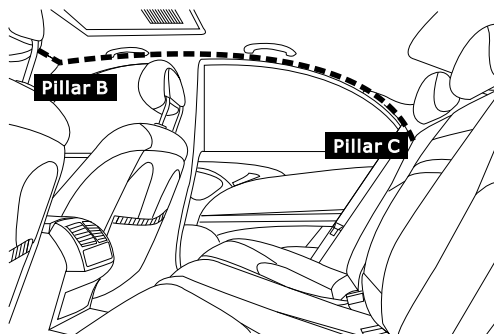

**Yellow - Constant 12V+ source.**

**Red - Ignition controlled ACC 12V+ source.**

**Black - Ground (-) Polarity (Connect to car chassis or ground point).**

**Green - Reverse Trigger (+) (Connect to reverse wire).**

### Step 3

Turn the vehicle on and verify that all the functions are working properly.

## Optional Accessories Installation

### VSM-UNI2 Installation Introduction (must mount back plate first)

#### Method 1 (Use Universal Mount Package)

- 1) Insert TOMBO 360X Mirror Back Plate for windshield mount onto the back side of the TOMBO 360X mirror, using provided screws.
- 2) Attach Universal mount onto the TOMBO 360X Back Plate using provided screws.
- 3) Select correct insert size for your vehicle's application.

Universal Mount Adaptor Size	Mount Adaptor Inserts Diameter
Small	14mm-21mm
Large	23mm-27mm

- 4) Mount TOMBO 360X onto factory stem and firmly secure the mount nut.
- 5) Adjust to the suitable angle to the mirror.

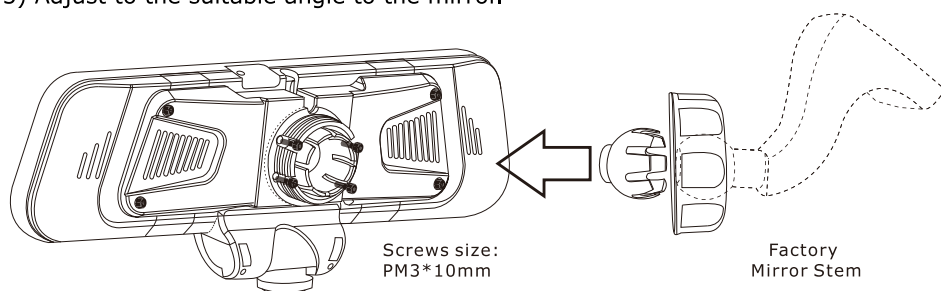

**Note:** If the diameter of the factory joint mount in your vehicle is 22mm, then you do not require the use of any Mount Adaptor Inserts.

#### Method 2 (Use the L-shape mount stem and universal mount package for rooftop application)

- 1) Insert TOMBO 360X Mirror Back Plate for windshield mount onto the back side of the TOMBO 360X mirror, using provided screws.
- 2) Attach the L-Shape Mount Stem to the backpack of the mirror using the provided washers and screws.
- 3) Attach the Universal Mount Adaptor to the L-Shape Mount Stem using the provided screws.
- 4) Select correct insert size for your vehicle's application.
- 5) Mount TOMBO 360X onto factory stem and firmly secure the mount nut.

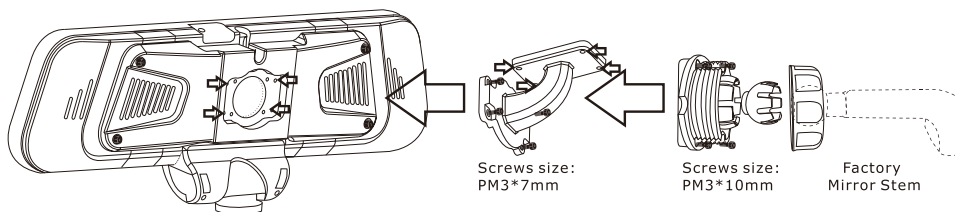

## BRK01 Installation Introduction

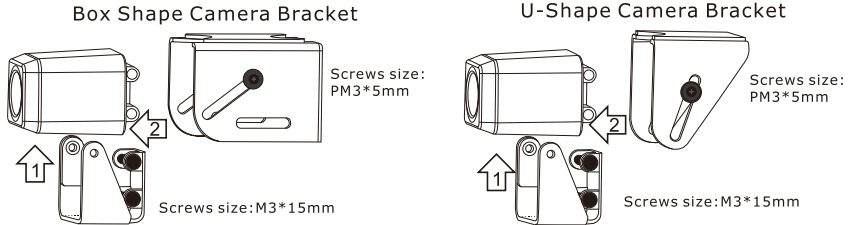

First, remove the Wing mount. Then, use the screws provided to secure the bracket with the rubber spacer to the backup camera as shown. Select between the Box Shape Camera Bracket or U-Shape Camera Bracket with a rubber spacer using the Screws provided according to the picture and adjust the angle.

## EXT-026 Installation Introduction

Connect EXT-026 according to the wiring diagram (page 10).

### NOTE:

The 6 PIN connector is for BSD blind spot monitoring systems (sold separately). Please contact Rydeen Tech Support at [tech1@rydeenmobile.com](mailto:tech1@rydeenmobile.com) or call 310-787-7880, toll-free 877-777-881 for more details.

## 5. User Interfaces

### Start-up Screen



### Power down Screen



## Main UI

When not recording



When recording



Tap the touch screen once to bring up the settings bar. Double-click the image in the lower right corner to display the backup camera in full screen mode. Slide the screen up or down to adjust the viewing angle of the rear camera. Double-tap the touch screen to exit full-screen mode and return back to the main screen.

## Video Recording Icon

The TOMBO 360X records at startup (default). When the system is recording, the icon will appear like . To enter the settings menu, you must stop recording. To stop/start recording simply press on the icon. The TOMBO 360X recording interval is 1min and 30sec for SOS files. The TOMBO 360X file is recorded in (H.264) format.

The following table can be used as a reference for data storage usage.

MicroSD Card Memory	Standard File	SOS File
16GB	52 min	24 min
32GB	105 min	49 min

**Note:** TOMBO 360X Maximum microSD card size is 256GB & Minimum storage required is 16GB. For new microSD card, it takes time for formatting and pre-allocating, bigger memory space takes longer.

### Photo Icon

Select the photo icon to take a snapshot. Images will be saved in ".jpeg" format inside the picture folder.

### Replay Video and View Photo Icon

Touch the  icon to enter the files for the front and backup camera recordings and view the snapshots. Recordings and images only viewable when system is not recording. To delete press and hold on desired file.

Select the  icon to view the recorded videos of the front camera.



Select the  icon to view the recorded videos of the backup camera.



Select the  icon to view the photos taken by the front and backup camera.





## File Lock Icon

While recording, press the  icon to record a 30-second SOS file. SOS files will be automatically locked.

## Setting Menu Icon

Select this icon to enter the settings menu.

Page 1

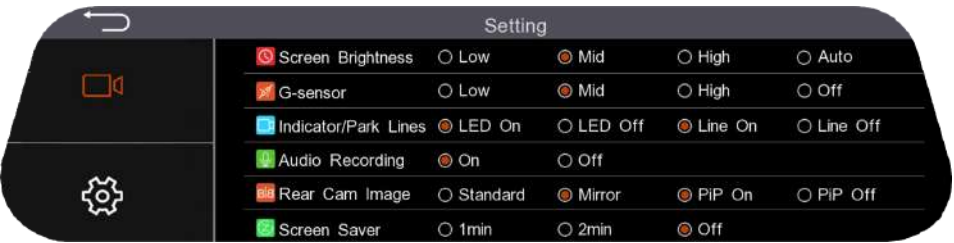

Screen Brightness----Selecting Auto will automatically adjust the screen brightness. When selecting either Low, Mid or High the screen will retain the same brightness level at all time.

G-sensor----Select the sensitivity of the G-sensor. The higher the selection, the higher the sensitivity of the G-sensor. Selecting "Off" will disable the G-sensor during normal operation. In sleep mode, G-sensor will be enabled.

Indicator/Park Lines----Indicator: Turn the LED indicator ON or OFF. In standby LED flashes. While recording, LED is off. Park Lines: Turn on or off the rear camera parking guidelines during reverse.

Audio Recording----Turn on or off the audio while recording, default setting is on.

Rear Cam Image----Control mirrored image displayed on the backup camera.  
PiP On (default)----Backup camera will display at the bottom right corner of the display.  
PiP Off----Backup camera view will not be displayed in the bottom right corner of the display.

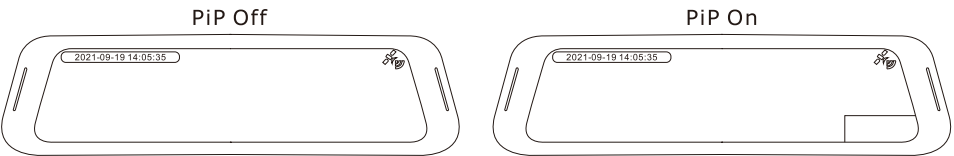

**Note:** When selecting "PiP Off" option, Reverse mode is disabled.

Screen Saver----Mirror will go into sleep mode after selected time has been reached with no usage. Selecting "Off" will keep display on during vehicle operation.

Page 2



Language---Select the system language, there are four languages (English, French, Spanish, and Japanese).



Sound Volume----Adjust System Volume.

Frequency----Select display refresh rate.

Time Setting----Time is determined by GPS positioning, including six manually selected time zones and one automatic time zone.

DST On----Turn on the Daylight-Saving Time.

DST Off----Turn off the Daylight-Saving Time.



When the GPS is successfully positioned, the GPS signal icon will appear in the upper right corner of the mirror and a green icon  will indicate connectivity. Otherwise, the GPS icon will display in red.

Press on the GPS icon to enter the GPS interface. Specific information such as latitude and longitude will be displayed.

GPS Time Zones for TOMBO 360X	
Time zone abbreviations	English
ET	Eastern Time
CT	Central Time
MT	Mountain Time
PT	Pacific Time
AKST	Alaska Standard Time
HST	Hawaii Standard Time
AST	Auto Select Time

System Setting----Select "Format" to delete all files in the microSD card. Select "Factory" to reset all settings back to default.



Software Version----Shows current software version installed in your device.

## Display Mode Selection Icon

Select this icon to view the different display modes.



## Screen Display Mode Introduction

TOMBO 360X has four screen display modes. With the exception of "Wide Mode", the camera should be positioned downward for the best viewing angle.

**360° Mode**

360°mode is the factory default display mode, which can be changed through the screen display mode selection icon. In this mode, you can swipe the screen left and right to view a 360-degree panoramic view of the inside and outside of the vehicle and view a particular perspective.

**Wide Mode**

In wide mode, the front camera should be facing forward to give you a super wide viewing angle. Viewing angle adjustment is not available within this mode.

**Split Mode**

In split mode, you can orientate each individual screen to view a specific perspective of the front of the vehicle and inside view of the vehicle.

**Tri-split Mode**

In this mode, the middle screen displays a 360-degree panoramic screen, the user can swipe left and right on the touch screen to view a specific perspective.

**Note:** Dash camera will memorize last view setting.

**To SSD Icon**

TOMBO 360X uses loop recording for file management. When the microSD card is full, the newly recorded video will overwrite the previously recorded videos. To prevent files from being overwritten by loop recording. Please select the "To SSD" icon to back up the files to an external storage device (maximum support 2T). Back up video files to the storage device when the ACC on. For your safety, please do not operate this feature until your vehicle has come to a complete stop. During the backup process, the system will prompt "Exporting files", and after the backup is completed, it will prompt "Export completed".



When using an external storage device to store the transferred files, you must first format the storage device using your PC in "exFAT" file system format.

**Note:** While backup is in process, DVR recording is disabled.

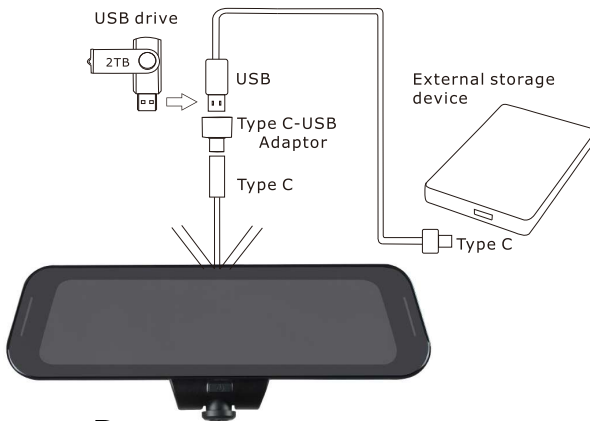

Please follow the diagram on the left to connect the Type C-USB adaptor to the external removable hard disk for backup. When connecting the Type C-USB adaptor, please allow 20 seconds for connection initialization to the TOMBO 360 system.

## Power Down

When turning off your ignition switch, you will be prompted to make one of the following selections.



## Power Off

### Note:

- When selecting this option, the TOMBO 360X will completely turn off and features like parking monitoring mode will be disabled. Please choose carefully.
- You can press and hold the power button to Power On/Off.

## Sleep

Select "Sleep" to enter parking monitoring mode. In parking monitoring mode, the Proximity and G-sensor will enable approximately one-minute after ACC is turned off. The G-sensor measures the movement of your vehicle through 3 axes – up and down, side to side, and front and back. When the G-sensor detects significant or sudden movement (such as an impact or collision) it will record an SOS video file recording. The external proximity sensor can detect motion within the field of view and record an

SOS video file. You can view the recorded SOS video files through the playback function on the mirror or on the PC backup, by using the dedicated video player.

**Note:** If the G-sensor is selected "Off" in the menu, the G-sensor will remain enabled during parking monitoring mode for vehicle safety.

## ⊘ CAUTION ⊘

Please do not remove or insert the microSD card while the product is running. Doing so, may damage the microSD card and the video may not be viewable. If you need to remove or insert the microSD card, please be sure that the TOMBO 360X is not recording. In the event of an accident, please remove the microSD card and store it in a proper place to prevent the video files from being overwritten. You can also use the "To SSD" function to back up to an external storage device.

## 6. Video Player Installation (PC Only)

TOMBO 360X uses Pre-allocating file management to provide you with a safer experience. If you need to play the video on your PC, please check the provided microSD card in the mirror.

There is a file named "Tombo360Setup" inside of folder "exe", please install and run the software on your PC.

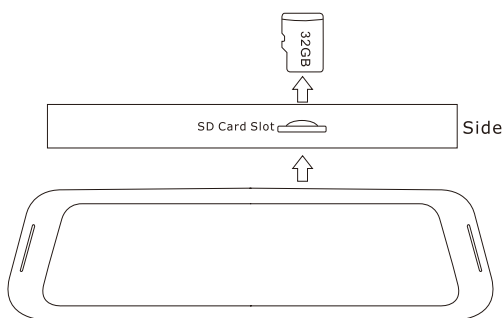

Follow the diagram on the left and use provided screw driver to remove the microSD card.

**Note:** TOMBO 360X uses Pre-allocating memory for file management. The system will generate 0-byte files in the folder during initialization. When recording videos are generated, the recording videos will occupy the 0-byte files one by one. Please use the provided video player in the microSD card to playback the recorded videos, if you want to view the videos on a PC.

## Pre-allocating File Management Instructions

As shown in the example right, the blue squares represent the recorded video files and the black squares represent the pre-allocated storage space. Assuming that the microSD card has only 7 pre-allocated storage spaces and the duration of video "3" and video "8" is half a minute and the other videos are 1 minute.

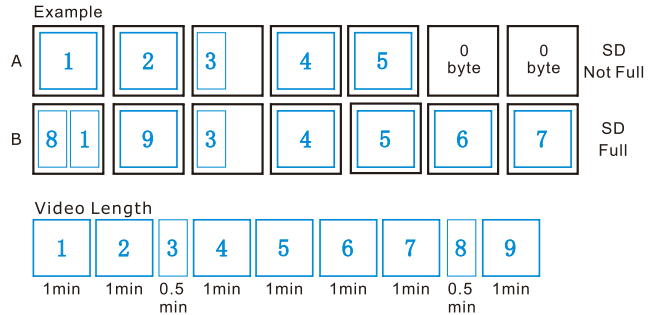

**Case A**, when the microSD card is not full, video "1", video "2", video "3", video "4", video "5" will be stored in the pre-allocated storage spaces in sequence. The remaining pre-allocated storage space will show 0-byte files.

**Case B**, when the microSD card is full. Since the storage device only has 7 the pre-allocated storage spaces, video "8" will occupy a portion of video "1" and video "9" will completely overwrite video "2".

## TOMBO 360X Video Player Instructions

### Tombo360 Viewer Menu





- 1) Version Check: Click on the software version number to update to the latest version available. Over the Air update support only available with online access.
- 2) Play Mode: Play mode switch. In selection gives three choices (Sequence, Random, Repeat).
- 3) Add: Add videos to list.
- 4) Del: Delete a single video.
- 5) Clear: Clear video file list.
- 6) Right mouse click to select speed unit display (MPH, KM/H).
- 7) Prev: Play previous video.
- 8) Pause/Play: Pause/play video.
- 9) Nex: Play next video.
- 10) Stop: Stop video playback.
- 11) Down: Playback video recording angle in downward facing view.
- 12) Top: Playback video recording angle in top facing view.
- 13) Front: Playback video recording angle in front facing view.
- 14) Split2: Display playback video in dual screen mode (front/back).
- 15) Split4: Display playback video in quad screen mode (front/back/left/right).
- 16) 360Surround: Playback video recording in 360 surround view.
- 17) Wide: Display playback video in wide angle.
- 18) Volume: Adjust the volume of the video.
- 19) Open: Open the folder to select video to play.
- 20) Convert: Convert recorded video files into MP4 format.
- 21) FullScreen: Full screen display.
- 22) Help: Instructions of the Tombo360 viewer.
- 23) Minimize: Hide the Tombo360 viewer display.
- 24) Maximize/Restore: Maximize/restore the Tombo360 viewer display.
- 25) Close: Close the Tombo360 viewer.

Tombo360 Rear Camera Viewer Menu





- 1) Zoom in: Zoom in the map.
- 2) Zoom out: Zoom out the map.
- 3) GPS trace playback.
- 4) Mirror On/Off: Display mirror/original image.

### Conversion

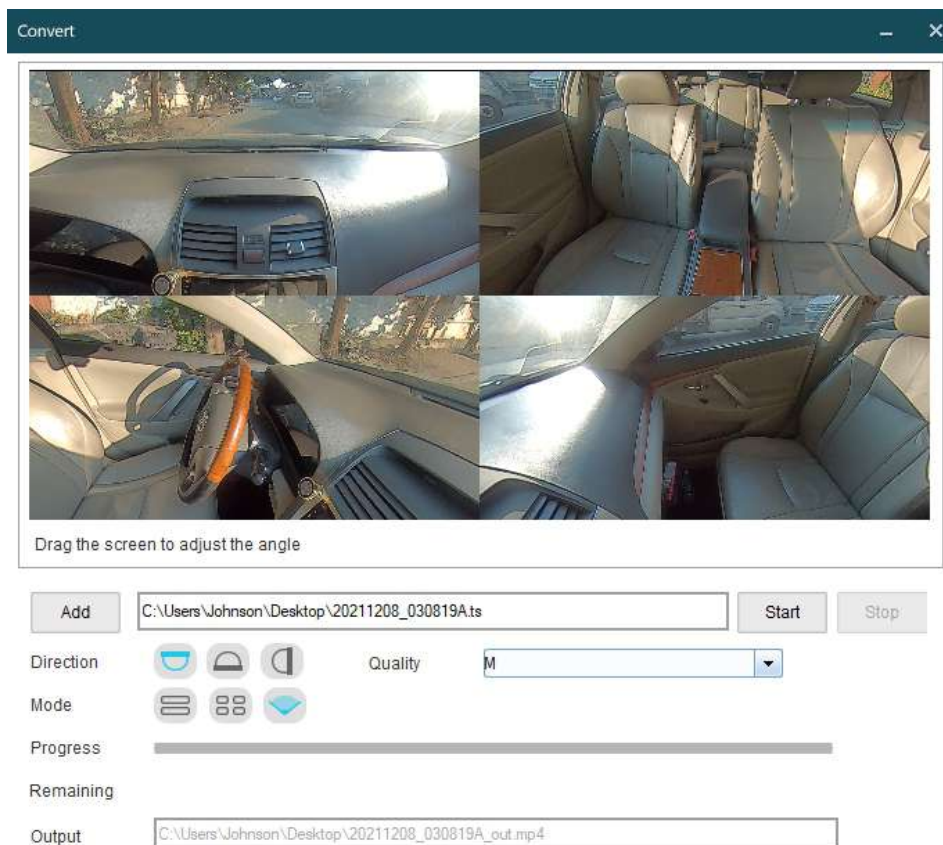

Add: Select the video file to be converted.

Direction: Select the front camera recorded direction.

Quality: Select the resolution of the video.

Mode: Select the video displayed mode. Only useful with front 360° camera.

Progress: Display the progress of the conversion.

Remaining: Displays the remaining time required for the video conversion to complete.

Output: Displays the saved location of the converted video.

**Note:**

1. The Tombo360 Viewer player is only compatible on Windows Operating Systems.
2. The Tombo360 Viewer player is compatible on Windows7 and newer.
3. When you use the conversion function, do not use the file storage path with Spaces, this will cause the video conversion to not work properly.

## 7. Specifications

Basic Parameters	
Video Input (backup camera)	AHD
System Language	English, Japanese, French, Spanish
Screen Dimensions	10 inches
Touch Screen Type	Resistive
Front Camera	1920*1920/ H360°/27.5 fps
Audio Line-Out	Built-in 8Ω/ 2W speaker*1 for audio/voice playback
Audio Power (Internal)	4Q2W
Power Supply Voltage	DC 10V to 24V
Rated Current	600mA
Super Capacitor Size	8.5*17*32MM
System	Linux
Storage	Built-in microSD card slot, External backup SSD
Operational Temperature	-10℃~ +60℃
Storage Temperature	-30℃~ +70℃
Operational Humidity	45%~80%RH
Storage Humidity	30%~90%RH
GPS Hardware Parameters	
Date Update Rate	1Hz
Warm Startup Time	1 Sec (average)
Cold Startup Time	<33 Sec (average)
Maximum Speed Rate	<280 m/s
GPS Antenna Gain	30dB
Power Voltage	3.3V
Backup Camera Parameters	
Construction	2G4P+1IR
Water Proof	IP67
Resolution	1920*1080
Viewing Angle	D140°, H118°, V61.5°(±5°)

## 8. Maintaining Your GPS

### Cleaning the Unit:

1. Use a soft, dry cloth to wipe away dirt.
2. If the dirt cannot be wiped away, dampen the cloth with water to clean the unit.  
**NOTE: Do not wash the unit with running water as this unit is not water proof.**
3. Use a dry cloth to wipe away residual moisture when done.  
**NOTE: Do not use solvent, car cleaner or organic cleaners to clean the unit. These substances may damage the GPS unit.**

### Cleaning the LCD Display:

1. Turn off the system while cleaning the display to prevent static electricity.
2. Use a soft, dry cloth to wipe away dirt.
3. The display surface is easily scratched. Do not use hard objects to scrape or come in contact with the display surface.

## 9. Technical Support Contact Info

For any questions about **TOMBO 360X**, please contact your retailer or RYDEEN Technical Support:

- Phone: **1-877-777-8811 (within USA only) or 1-310-787-7880**
- Email: [tech1@rydeenmobile.com](mailto:tech1@rydeenmobile.com)
- Web: <https://rydeenmobile.com/contact-support/>

## 10. One Year Limited Warranty

RYDEEN MOBILE (a manufacturer of "RYDEEN" products) warrants products (TOMBO 360X) only to the original purchaser as described following:

### Warranty Period

Rydeen warrants this product for a period of one (1) year from the original purchase date.

## Warranty Coverage

This warranty covers all defects in material and workmanship except as specified below.

1. Any products distributed outside of the USA by Rydeen North America, Inc. (Rydeen) or which is not purchased in the USA or Canada unless the product is purchased through the USA Military Exchange Service.
2. Any product(s) which are purchased from an unauthorized retailer (in store or online).
3. Any products in which the serial number label or the model number label are removed, torn, modified or replicated.
4. Any damage defects or malfunctions resulting from any of following:
  - a) When defect occurs during shipment of product (freight carrier's responsibility).
  - b) Installation or removal of product.
  - c) Accidents, act of nature, misuse, abuse, neglect, unauthorized product modification or failure to follow product owner's manual instructions.
  - d) Any repair or attempt to repair without RYDEEN authorization.
  - e) Any other cause which is not related to product defect.
  - f) Any cosmetic damages due to normal wear and tear.
  - g) Any consumable items (such as fuse or batteries).

If any problems develop with your Rydeen products during or after the Limited Warranty Period, or if you have any questions regarding the operation or installation of the product, you should contact your Rydeen retailer. If the problem or your question is not handled to your satisfaction, please contact Rydeen Customer Service Department at 1-877-777-8811 (within the USA only) Monday-Friday between 9:00 AM to 4:00 PM Pacific Standard Time or visit [www.rydeenmobile.com](http://www.rydeenmobile.com).

## 11. To Obtain Warranty Service

If warranty service is required for your Rydeen product:

1. Please call Rydeen Customer Service Department at 1-877-777-8811 (within the USA only), Monday-Friday between 9:00 AM to 4:00 PM Pacific Standard time and obtain a Return Authorization Number ("RA") Number.
2. Please pay for any shipping charge to Rydeen Customer Service Department. Rydeen will pay the return shipping charge, if the repair or service was performed during the warranty period. Rydeen will ship freight collect (recipient is responsible for shipping charge) if Rydeen determine the service was performed outside of warranty period or exclusions described above. Rydeen will not accept warranty service requests from outside of the U.S.A. even if product was purchased in the USA.

3. Please include a copy of your original purchase receipt including Rydeen product model number, purchase date, retailer name/address and a RA Number whenever your product is sent for warranty service.
4. Rydeen will pay for all labor and material expenses for covered product during warranty period.
5. Shipping address for Rydeen Customer Service Department is following:  
Rydeen North America, Inc. (a manufacturer of Rydeen products), 2701 Plaza Del Amo, Unit 705, Torrance, California 90503, USA.

## 12. FCC Compliance Statement

This device complies with Part 15 of the FCC interference limits for Class B digital devices for home or office use. These limits are designed to provide more reasonable protection against harmful interference in a residential installation and are more stringent than "outdoor" requirements.

Operation of this device is subject to the following conditions:

1. This device may not cause harmful interference, and
2. This device must accept any interference received, including interference that may cause undesired operation.

## 13. Copyright

1. Intellectual Property Rights of Software are proprietary to RYDEEN North America, Inc. or its suppliers and are subject to copyright and other intellectual property laws. Client's only rights with respect to any RYDEEN North America, Inc. software included with the products shall be provided, under the terms of RYDEEN North America, Inc. software license. The title to all RYDEEN North America, Inc. Software remains with RYDEEN North America, Inc. Client agrees that RYDEEN North America, Inc. retains ownership of all rights, title and interest in all intellectual property, works of authorship, trade secrets and the like in all aspects of the Product(s). Client and its affiliates and subcontractors agree not to reverse engineer any aspect of the Software and/or Products supplied under this agreement and further agree to pay assessed damages should such action take place.
2. Copyright and Copies. The Software (including any copy thereof) is owned by RYDEEN North America, Inc. or its suppliers and is protected by United States, Canadian, European, Brazilian and Australian copyright and patent laws and international treaty provisions. The Software copy is licensed to you the client, not sold to you, and you (the client) are not an owner of any copy thereof. You may make one copy of the software for backup or archival purposes. You may not otherwise copy the software, except as authorized by applicable law, nor the written materials accompanying the Software. RYDEEN North America, Inc.

---

hereby reserves all rights not explicitly granted in this license agreement.  
Software Copyright © 2022, RYDEEN North America, Inc.

## 14. Disclaimer

The information in this user's manual is for general guidance. The images in the manual may be similar to the images shown in the actual product, but they do not exactly match. Depending on the optional package, some functions described in the manual may not be available or the functions described may be restricted.

## 15. Troubleshooting

### Solutions for Common Problems

1. NO display: Check to ensure the screen cable is properly connected and terminal connection is not loose.
2. On Screen start-up if display appears green: Please wait a moment as TOMBO 360X will analyze issue and restart.
3. Rydeen logo stuck on screen start-up. Please insert a small pin into the reset hole and restart.
4. "Please Connect Storage Device" is displayed in the upper right corner of the screen: Please confirm whether you have inserted the microSD card. If you have inserted and this is the first time you using the TOMBO 360X, please format microSD card.
5. GPS suddenly no signal:
  - a) You have entered a tunnel or other area where there is no GPS signal.
  - b) Please check whether the GPS cable is loose or disconnected.
6. GPS Time Zones shows wrong time: This may be that the time zone of your area cannot be accurately identified by GPS. Please manually select your time zone in "Time Setting".

### Other Problems

1. No video (screen without red dots):
  - a) The microSD card is not formatted or corrupted.
  - b) The microSD card is not inserted in place.
2. The video freezes when playing on the computer, and the video is not coherent:
  - a) Use TOMBO 360X dedicated player to play.
  - b) Replace with a formatted high-speed card.
3. The recorded video is hazy or blurry: Check if the lens is dirty.





[rydeenmobile.com](http://rydeenmobile.com)

Rydeen North America, Inc.

2701 Plaza Del Amo, Suite 705, Torrance, California 90503 USA

Phone: 1-877-777-8811 Fax: 1-310-943-3778

Copyright © 2022 Rydeen North America, Inc. All Rights Reserved.

RYDEEN ® is a registered trademark of Rydeen North America, Inc.

These materials are protected by copyright law and international treaties. Any unauthorized use, reproduction or distribution of these materials, or any portion herein, will result in severe civil and criminal penalties and fines.

Violators will be prosecuted to the fullest extent of the law.